

AA6871

Memorandum of common provisions

Section 91A Transfer of Land Act 1958

Privacy Collection Statement

The information in this form is collected under statutory authority and is used for the purpose of maintaining publicly searchable registers and indexes.

Lodged by:

Name: HWL EBSWORTH LAWYERS
Phone: +61 3 8644 3500
Address: Level 26, 530 Collins Street
Melbourne VIC 3000
Reference: SJS:CDW:1018299 (Stage 20, BEP MCP)
Customer Code: PEXA 19208S

This memorandum contains provisions which are intended for inclusion in instruments and plans to be subsequently lodged for registration.

Provisions:

Recitals:

- A. This MCP contains the Building Envelope Plans applicable to the lots in the Plan of Subdivision.
- B. This MCP, in conjunction with the memorandum of common provisions no. AA3379, provides the information necessary to interpret the Approved Building Envelope.

1. Definitions:

Approved Building Envelope has the meaning given to that term in the Regulations;

Building has the same meaning as in the Building Act;

Building Act means the act of the Victorian Parliament known as the *Building Act 1993* (Vic) and any re-enactment or replacement of that Act;

Building Envelope Plan means the building envelope plans contained in this MCP;

MCP means this memorandum of common provisions;

Plan of Subdivision means the plan of subdivision no. PS827500T for Stage 20, Modeina;

Regulations mean the *Building Regulations 2018* (Vic) or any subsequent regulations made pursuant to the Building Act which relate to the siting of a Building.

2. Building Envelope Plan:

See Building Envelope Plans in subsequent pages.

35271702A

V3

- 1. The provisions are to be number consecutively from number 1.
- 2. Further pages may be added but each page should be consecutively numbered.
- 3. To be used for the inclusion of provisions in instruments and plans.

91ATLA

Page 1 of 3

THE BACK OF THIS FORM MUST NOT BE USED

Land Use Victoria contact details: see www.delwp.vic.gov.au/property>Contact us

AA6871

Memorandum of common provisions Section 91A Transfer of Land Act 1958

BUILDING ENVELOPE PLAN

SHEET 2 OF 2

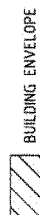
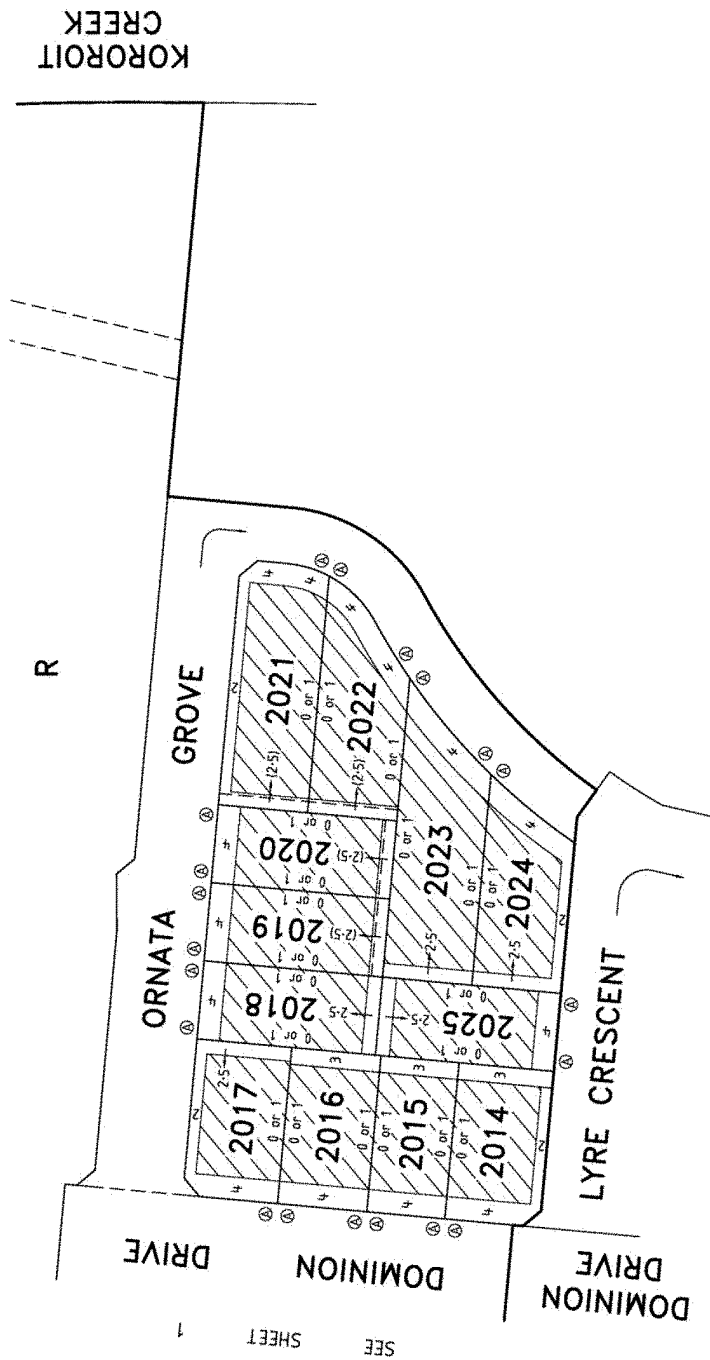
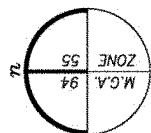

MODEINA - STAGE 20



Level 3, 1 Southbank Boulevard
Southbank, Victoria 3006
(03) 7019 8400
www.veris.com.au
DEVELOP
WITH
CONFIDENCE™

REF: 329559-ST20
DWG: 329559-ST20-BB
DATE: 12 NOVEMBER 2020
SCALE: 1:1000 @ A4

91ATLA

Page 3 of 3

THE BACK OF THIS FORM MUST NOT BE USED

Land Use Victoria contact details: see www.delwp.vic.gov.au/property>Contact us

V3